



Broomlea

North Shields, NE29 8AN

Fresh Property Centre is delighted to offer for sale this beautifully presented, three bedroom, mid link home situated on Broomlea in North Shields. The accommodation comprises: entrance hall, lounge, conservatory, and modern kitchen. To the first floor there are three bedrooms and a bathroom/WC. Externally there is parking to the front and a rear garden. Lovingly updated by the current owner, viewing is essential.



Offers Over £140,000



0191 257 6823

www.fresh.property

hello@fresh.property

63 Church Way, North Shields, Tyne & Wear, NE29 0AE



Zoopla

rightmove

PrimeLocation

OnTheMarket.com

Entrance Hall

Via composite door. Built in cupboard, laminate flooring, feature radiator, spot lights, under stairs storage and stairs to first floor.



Lounge

Laminate flooring, spot lighting, radiator and double glazed double doors to conservatory.



Conservatory

Double glazed conservatory, laminate flooring, spot lights, power points and double glazed double doors to rear.



Kitchen

Modern matching base and wall units with work surfaces over, sink with drainer and mixer tap, built in oven, built in microwave, four ring gas hob with extractor fan over, integrated washing machine and double glazed window.



Landing

Loft access and spot lighting.



Bedroom One

Built in wardrobes, radiator and double glazed window.



0191 257 6823

www.fresh.property

hello@fresh.property

63 Church Way, North Shields, Tyne & Wear, NE29 0AE



Zoopla

rightmove

PrimeLocation

OnTheMarket.com



Bedroom Two

Feature radiator and double glazed window.



Bedroom Three

Feature radiator and double glazed window.



Please Note: All measurements are approximate and quoted in metric with imperial equivalents and for general guidance only and whilst every attempt has been made to ensure accuracy, they must not be relied on. The fixtures, fittings and appliances referred to have not been tested and therefore no guarantee can be given that they are in working order. Internal photographs are reproduced for general information and it must not be inferred that any item shown is included with the property.

Bathroom

Modern three piece bathroom suite comprising; panelled bath with mixer tap and shower over, vanity hand wash basin and low level WC. Heated towel rail, spot lights and extractor fan.



Front

Single drive way and pebbled area.

Rear

Patio area and artificial grass area.



Thinking of Moving?

Fresh can help you;

- Sell your home
- Arrange a mortgage
- Select a local solicitor

Call our team to see how we can help

0191 257 6823

www.fresh.property

hello@fresh.property

63 Church Way, North Shields, Tyne & Wear, NE29 0AE



Zoopla

rightmove

PrimeLocation

onTheMarket.com

Ground Floor

Approx. 36.5 sq. metres (392.8 sq. feet)

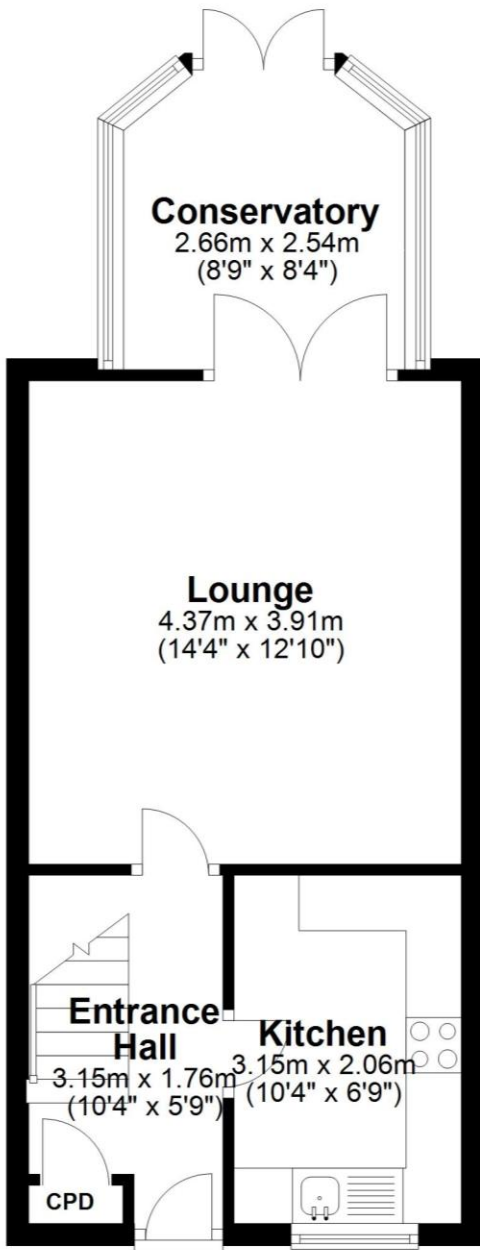

First Floor

Approx. 29.9 sq. metres (321.3 sq. feet)

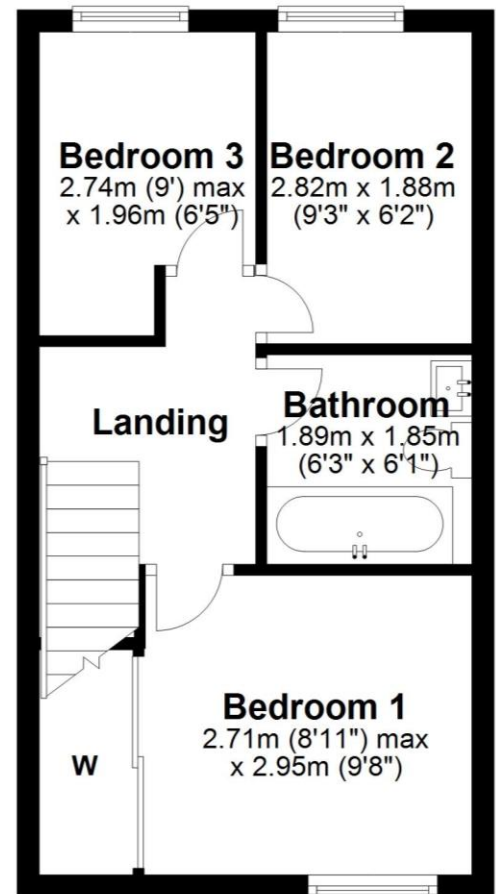

Total area: approx. 66.3 sq. metres (714.1 sq. feet)

The floor plan is for illustrative purposes and is not to scale. Where measurements are shown, these are approximate and should not be relied upon. Sanitary ware and kitchen fittings are representative only and approximate to actual position, shape and style. No liability is accepted in respect of any consequential loss arising from the use of this plan.

0191 257 6823

www.fresh.property

hello@fresh.property

63 Church Way, North Shields, Tyne & Wear, NE29 0AE



Zoopla

rightmove

PrimeLocation

onTheMarket.com